

Series DT220

“OR” Valve (Shuttle Valve)

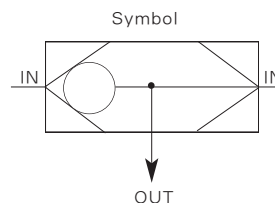

- 3 ported check valve with one output and 2 pneumatic signal input ports.
- Output always supplied by high pressure inlet



How to Order

U DT 220 — **02**

1
2
3

1 Series DT220

Blank : Metric (PT)
U : NPT (UNF)

2 Thread

Blank : Rc (PT)
G : Rc (PF)

3 Port Size

02 : 1/4"

Construction/Dimensions

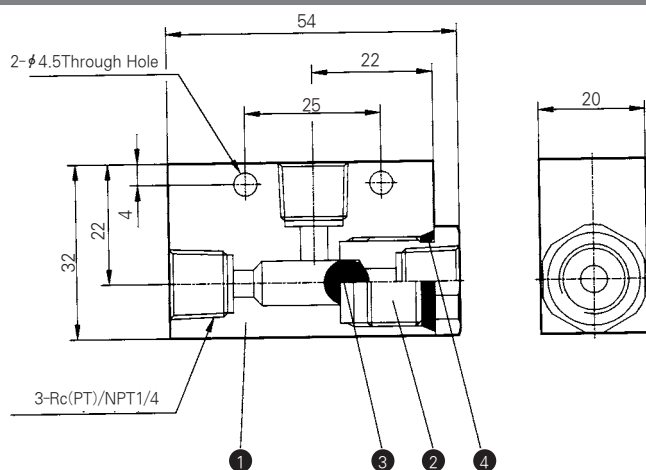

Model/Specifications

Model	UDT 220-02
Port Size	Pc(PT)/NPT 1/4"
Max. Operating Pressure	9.9 kPa (140.8psi)
Min. Pressure Differential	50 kPa (7.1psi)
Ambient and Fluid Temperature	0~60° C (32~140° F)
Effective Area (Cv)	19mm ² (1.0)

Component Parts

No.	Description	Material	Notes
1	Body	Aluminum Alloy	
2	Bush	Brass	
3	Ball	N.B.R	
4	Gasket	N.B.R	

Structures

DC Type

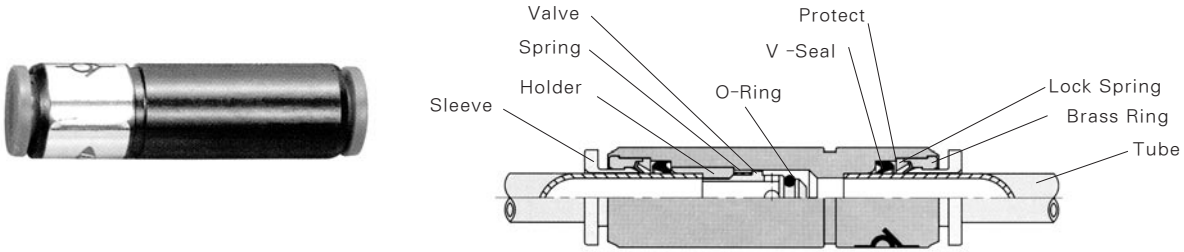

Dimensions

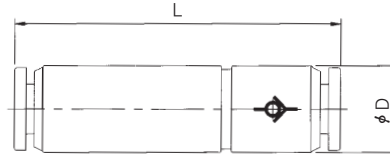

Unit: mm(inch)

Model	Tube size	L	D
DC-04	4	41.7(1.64)	10.6(0.42)
DC-06	6	47.9(1.89)	12.6(0.5)
DC-08	8	51.5(2.03)	14.6(0.57)

Specifications

Fluid Admitted	Air, Vacuum
Working Pressure kPa(psi)	20~99KPa(2.8~140.8psi)
Temperature Range	0~60℃(32~140°F)

FEATURES

- The Check Valve permits the air flow in one direction but checks the flow in the opposite direction, thus keeping the output Pressure at a constant level.

DW

DV100

DV1000 ·
3000 · 4000

DS300

DS3000

DS5000

DS2000

DX2R

DP300 ·
3000 · 5000

DS6000

DX2

DM

DH

DT220

DC